



United States Department of the Interior



NATIONAL PARK SERVICE  
NATIONAL CAPITAL REGION  
1100 OHIO DRIVE, S. W.  
WASHINGTON, D.C. 20242

TELECOPY TRANSMITTAL COVER SHEET  
FAX #202-

TO: RICK BUSH

DATE: 3 20 96

LOCATION: \_\_\_\_\_  
\_\_\_\_\_

523.6145

TELEPHONE: FAX: \_\_\_\_\_ REGULAR: \_\_\_\_\_

FROM: MARK CLAPP PHONE: 202.523.6145

NUMBER OF PAGES: 2 (Including cover sheet)

SUBJECT: RESERVATION 146 PLANT MATERIALS  
ESTIMATE

HANDLING INSTRUCTIONS:

- High Priority (Deliver to Addressee immediately) \_\_\_\_\_
- Call (202) 523- To Confirm Receipt \_\_\_\_\_
- Call (202) 523- When Review Completed \_\_\_\_\_
- Normal Processing \_\_\_\_\_
- Confidential (Adressee Eyes Only) \_\_\_\_\_
- Other \_\_\_\_\_

Sat - May 4th all day times  
- mike ok out to?

NEW HAMPSHIRE AVENUE, N.W.

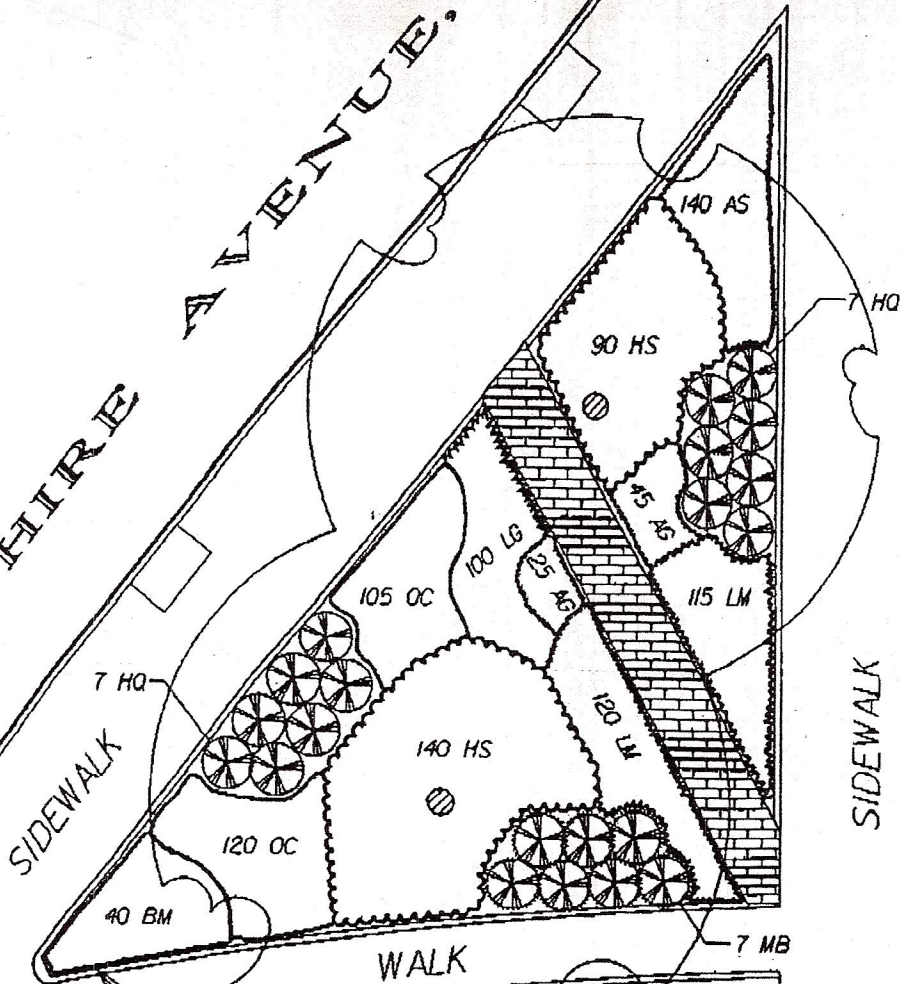

16TH STREET NW

## PLANT MATERIALS LIST

KEY	QUANTITY	BOTANICAL NAME	COMMON NAME	SIZE	COMMENTS
HQ	14	HYDRANGEA QUERCIFOLIA 'SNOW QUEEN'	OAKLEAF HYDRANGEA	12 TO 14" 2 GAL CONT.	4'-0" OC.
MB	7	MAHONIA BEALEI	LEATHERLEAF MAHONIA	12 TO 14" 2 GAL CONT.	4'-0" OC.
AS	140	ASTILBE SIMPLICIFOLIA 'SPRITE'	SPRITE ASTILBE	2 QUAR CONT.	12" OC.
AG	70	ATHYRIUM GOERINGIANUM 'PICTUM'	JAPANESE PAINTED FERN	1 QUART CONT.	12" OC.
BM	40	BRUNNERA MACROPHYLLA	SIBERIAN BUGLOSS	1 GALLON CONT.	18" OC.
HS	230	HOSTA SIEBOLDIANA 'ELEGANS'	HOSTA	1 GALLON CONT.	18" OC.
LG	100	LAMIASTRUM GALEODOLON 'VARIEGATUM'	YELLOW ARCHANGLE	1 QUART CONT.	12" OC.
LM	235	LIRIOPE MUSCARI	BIG BLUE LILYTURF	1 QUART CONT.	12" OC.
OC	225	OSMUNDA CINNAMOMEA	CINNAMON FERN	2 QUAR CONT.	12" OC.

ATION 146  
MATERIALS  
ESTIMATE  
MARCH 20, 1996  
PREPARED BY: M. CLAPP

QTY	BOTANICAL NAME	COMMOM NAME	UNIT PRICE	TOTAL
14	<i>Hydrangea quercifolia</i> 'snow queen'	oakleaf hydrangea	\$17.00	\$238.00
7	<i>Mahonia bealei</i>	leatherleaf mahonia	16.00	112.00
140	<i>Astilbe simplicifolia</i> 'sprite'	sprite astilbe	2.90	406.00
70	<i>Athyrium goeringianum</i> 'pictum'	Japancse painted fern	2.00	140.00
40	<i>Brunnera macrophylla</i>	siberian bugloss	3.00	120.00
230	<i>Hosta sieboldiana</i> 'elegans'	hosta	5.00	1,150.00
100	<i>Lamisdtrum galeobdolon</i> 'variegatum'	yellow archangle	1.50	150.00
235	<i>Liriope muscari</i>	big blue lilyturf	1.75	411.25
225	<i>Osmunda cinnamomea</i>	cinnamon fern	2.50	562.50
GRAND TOTAL:				\$3,289.75